

One Series

Traditional forming methods combined with ICF

Product Overview

The one series offers users the ability to reduce labour by eliminating the need to strip foam for elevator strips, stairwells and other areas that require a non-combustible finish. The one series provides architects the ability to have more versatility with design for educational and residential properties.

For home builders, the one series is ideal for pools and anywhere only one side of foam is required. Transition between concrete and foam is seamless, the unique design allows concrete to meet with the outside edge of Nudura foam panel. The Dura multi-link tie uses attachment points that have been created to alleviate webs being visible on the concrete side of the wall. This innovation design features only two small connection points per web that are easily covered over and hidden. The end result is a smooth interior or exterior concrete surface.

Features & Benefits

- Industry's first multi-link form
- Reduced labour - no need to strip foam
- Design versatility
- Features Nudura's innovative patented technologies
- Concrete core widths from 168mm to 371mm

The one series features DURAMAX technology, the industries largest standard form on the market, 2.4m long by 457mm high placing 1.1m² of wall area in one building step.



Faster build time



Simplified assembly



Sustainable solution

Our goals are simple, we are committed to provide customers with a high-quality solid wall insulated form work, that will work in reducing energy costs, and contribute to living in a much more sustainable, air quality controlled and comfortable living environment. When specifying and using Nudura on projects you can be assured that you are using the best modern method of construction solution available in the marketplace today.

Download our product guide here

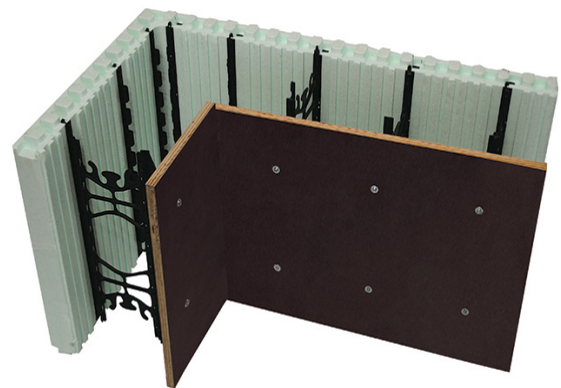
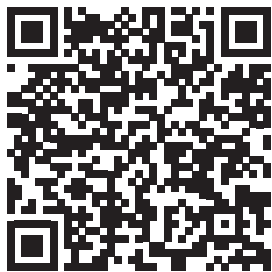

Tremco CPG UK Limited
Coupland Road, Hindley Green
Wigan WN2 4HT UK

T. +44 1942 251400
F. +44 1942 251410
hello@cpg-europe.com
www.cpg-europe.com